

Wissper

Bird house

You need:

- 1 clean milk carton
- acrylic paint
- scissors, glue
- 1 solid branch
- 1 string, 50cm
- birdseed
- things to decorate: woodsticks, buttons, pebbles ...
- acrylic pen

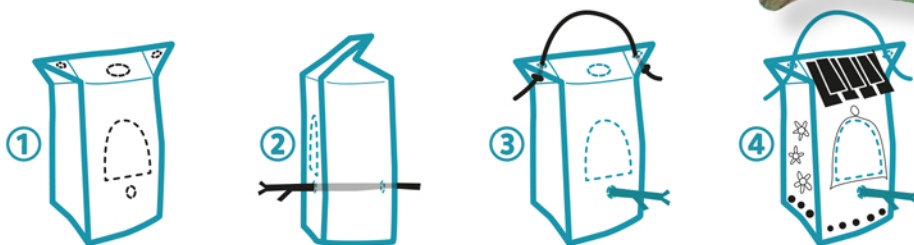

1. Cut an opening with the measures 7 x 5cm into the front of the box. Stick a hole for the branch about 1,5cm under the opening and into the opposite site of the package. Cut off the lid and stick two little holes next to it into the ears on the top of the box.

Now you can paint the carton in your favourite colours. Use waterproof paint.

2. Stick the branch through the carton and fix it with glue.

3. Thread a string through the small holes in the top. Fasten the ends with knots.

4. Now you can decorate your Birdhouse with natural materials, buttons or patterns.

Fill the house with birdseed and put it outside on a winterly tree.

